

NOTES: 1. ON LYCOMING INSTALLATION (EXCEPT O-320-H2AD), SAFETY WIRE TENSION ARM BOLTS MS20074 - 05 - 06 & AN5H-5A. ON LYCOMING O-320-H2AD INSTALLATION, SAFETY WIRE TENSION ARM BOLTS MS20074-05-12 & AN5H-5A. ON CONTINENTAL INSTALLATION, SAFETY WIRE TENSION ARM BOLTS AN5H-5A & MS2007 - 05 - 12. FOR CONTINENTAL TURBO INSTALLATION, SAFETY WIRE TENSION ARM BOLT AN5H-13A. USE .032" SAFETY WIRE.

REVISIONS				
EN	REV.	DESCRIPTION	BY	DATE
1409005	M	FIRST RELEASE INTO HET DESIGN DATA	BJ	9/3/14
1409006	N	1) TITLE BLOCK WAS PLANE POWER, LTD 2) "HARTZELL ENGINE TECHNOLOGIES, LLC" WAS "PLANE POWER, LTD" 3) "SHEET 2" WAS "REVERSE SIDE" 4) ADDED 10-1031 CALLOUT TO DATA TAG 5) 10-1050A WAS AL12-C60 6) 10-1050C WAS AL12-F60C 7) REMOVED DATA TAG MATERIAL NOTE	BJ	9/3/14
1411044	P	1) ON SHEET 1, "MAINTENANCE" WAS "CONTINUED AIRWORTHINESS"; 2) ON SHEET 2, "MAINTENANCE INSTRUCTIONS" WAS "INSTRUCTIONS FOR CONTINUED AIRWORTHINESS"	OKQ	11/19/14

MODEL: AL12 - F60C
(FOR CONTINENTAL
INSTALLATION)

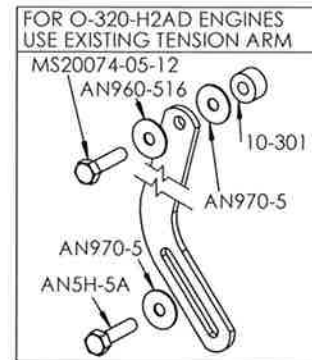
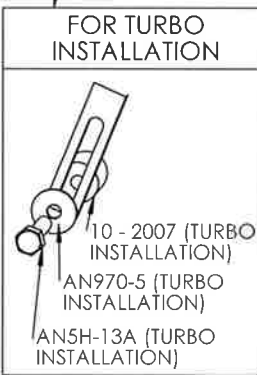
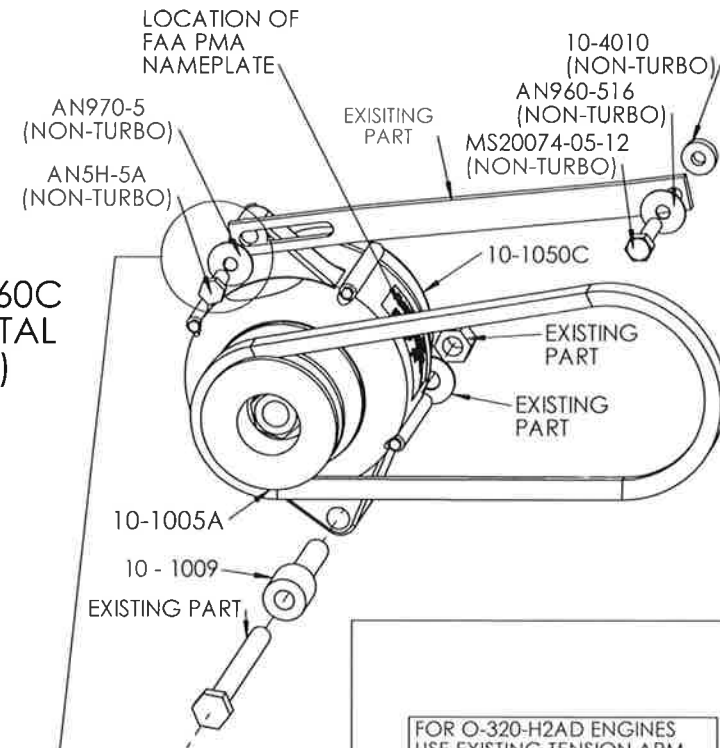

MODEL: AL12 - F60
(FOR LYCOMING
INSTALLATION)

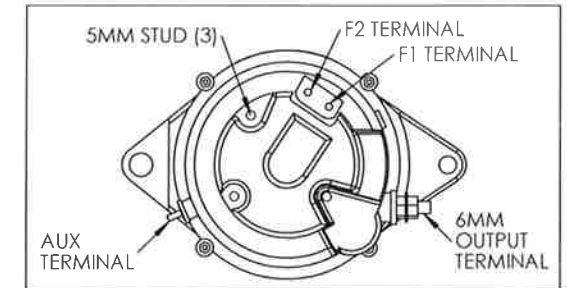
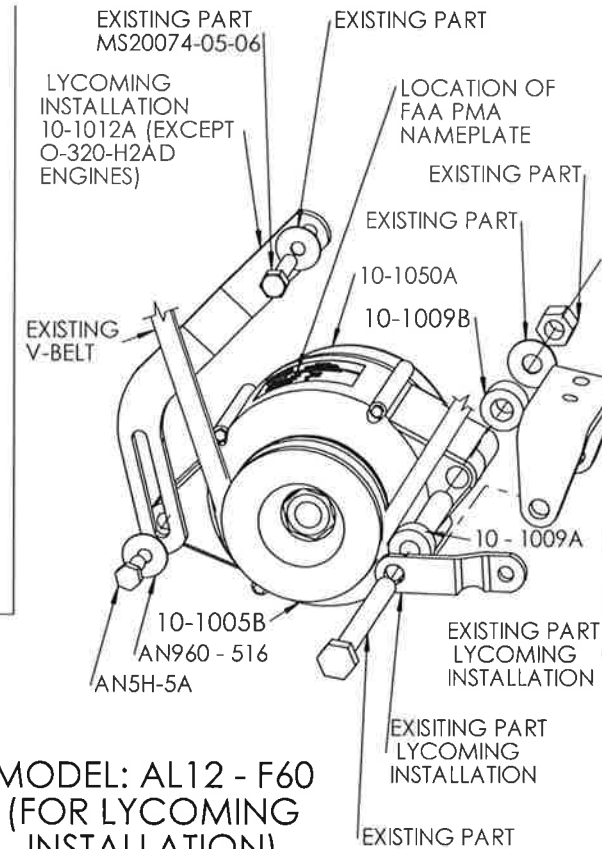

10-1031

Plane Power FAA PMA
HARTZELL ENGINE TECHNOLOGIES, LLC
For eligibility see www.plane-power.com/catalog

MODEL NO. 10-1050A
SERIAL NO. 2V-YWWSN
VOLTAGE 12

10-1031

Plane Power FAA PMA
HARTZELL ENGINE TECHNOLOGIES, LLC
For eligibility see www.plane-power.com/catalog

MODEL NO. 10-1050C
SERIAL NO. 2V-YWWSN
VOLTAGE 12

UNLESS OTHERWISE SPECIFIED
DIMENSIONS ARE IN INCHES AND APPLY
AFTER HEAT TREAT AND PLATING
.X = ±.015
.XX = ±.010 ANGLES ±1°
.XXX = ±.005
BREAK ALL EDGES AND MACHINE ALL
INSIDE CORNER FILLETS .015 MAX.
SURFACE FINISH

GEOMETRIC SYMBOLS PER ANSI Y14.5	
FLATNESS	
STRAIGHTNESS	
ROUNDNESS	
CYLINDRICITY	
PROFILE	
PERPENDICULARITY	
POSITION	
CONCENTRICITY	
SYMMETRY	
ANGULARITY	
PARALLELISM	
CIRCULAR RUNOUT	
TOTAL RUNOUT	

SCALE NTS

DRAWN	BJ	2/15/05
CHECKED	EAB	11/19/14
ENG.	RJQ	11/19/14
FINISH	N/A	
WEIGHT	N/A lbs	
MATERIAL SEE INDIVIDUAL COMPONENTS		
SIZE	SH 1 OF 2	CODE ID 65PY1



SPECIFICATION CLASSIFICATION		
CLASSIFICATION	DIMENSION CONVENTION	NOTE NO CONVENTION
CRITICAL	<XX.XX>	<#>
MAJOR	[XX.XX]	[#]
MINOR	XX.XX	#
REFERENCE	(XX.XX)	(#)

THIS DRAWING CONTAINS INFORMATION THAT IS CONFIDENTIAL AND PROPRIETARY TO HARTZELL ENGINE TECHNOLOGIES. THIS DRAWING IS FURNISHED ON THE UNDERSTANDING THAT THE DRAWING AND THE INFORMATION IT CONTAINS WILL NOT BE COPIED OR DISCLOSED TO OTHERS EXCEPT WITH THE WRITTEN CONSENT OF HARTZELL ENGINE TECHNOLOGIES, WILL NOT BE USED TO THE DETRIMENT OF HARTZELL ENGINE TECHNOLOGIES, AND WILL BE RETURNED UPON REQUEST BY HARTZELL ENGINE TECHNOLOGIES.

AL12-F60/AL12-F60C INSTALLATION INSTRUCTIONS		
DRAWING NO.	REV.	
10-4001	P	

INSTALLATION AND MAINTENANCE
INSTRUCTIONS ON SHEET 2



Part No. 10-4001

Installation Instructions

1. Disconnect aircraft battery.
2. Install alternator per included drawing.
3. Refer to appropriate engine and airframe service manuals for belt tension and bolt torques.
4. Install battery wire with MS25171-2S terminal nipple on 6mm output terminal and torque to 50 in. lb.
5. Install ground wire to any of the three 5mm studs on rear of alternator and torque to 35 in. lb.
6. Install field wire with MS25171-1S terminal nipple to F1 terminal on rear of alternator and torque to 20 in. lb.
7. NOTE: F2 terminal to remain grounded with ground strap UNLESS aircraft voltage regulator is a type "A" regulator using a 2-wire field circuit, in this case remove and discard ground strap from F2 terminal and connect wiring from voltage regulator to F1 and F2 terminals, torque to 20 in. lb.
8. If aircraft is equipped with an "alternator out light" circuit, connect that wire to the AUX terminal and torque to 20 in. lbs. Other wise leave AUX terminal open.
9. Reconnect aircraft battery.
10. Start aircraft and check alternator output for proper operation.

Maintenance Instructions

Annual / 100 hour inspections:

1. Remove drive belt and turn alternator rotor to check condition of bearings for abnormal noise or roughness.

5 year or 1,000 hour intervals:

1. Repeat: Annual / 100 hour inspection.
2. Remove field brush assembly and inspect brushes for excess wear. Replace brush assembly if brushes extend less than .250" from edge of brush holder case.